

TERMS OF REFERENCE / SCHEDULE OF REQUIREMENT

ENVIRONMENTAL AND SOCIAL IMPACT ASSESSMENT FOR A MEDICAL WASTE FACILITY AT KIBAHA FOR TANZANIA MEDICINE AND MEDICAL DEVICES AUTHORITY (TMDA)

1. Background

UNOPS has been requested by the the Ministry of Health, Community Development, Gender, Elderly and Children (MoHCDGEC) and the Global Fund to Fight Aids, TB and Malaria (GFATM) and to support agencies fulfil their mandates. In this regard, UNOPS is supporting the Tanzania medicines and medical devices authority (TMDA) in the setting up of a medical waste management facility at Kibaha, Dar es salaam, Tanzania.

This support is broken into two phases, phase 1 involves the assessment of the suitability of the proposed site for construction and installation of a medical waste facility, development of a concept design and technical specifications for the incinerator. The second phase will involve the detailed design of the facility and implementation.

UNOPS seeks to engage a consultant to carry out an environmental impact assessment as per the requirements set out below:

2. Site layout

The site (sites 1 and 2) to be studied and where the proposed medical waste facility will be set up is shown on the Google earth below. The site coordinates are **6°46'12.9"S 38°47'36.0"E**



Google earth image showing location of the site 1 and 2 where the medical waste facility is to be set up

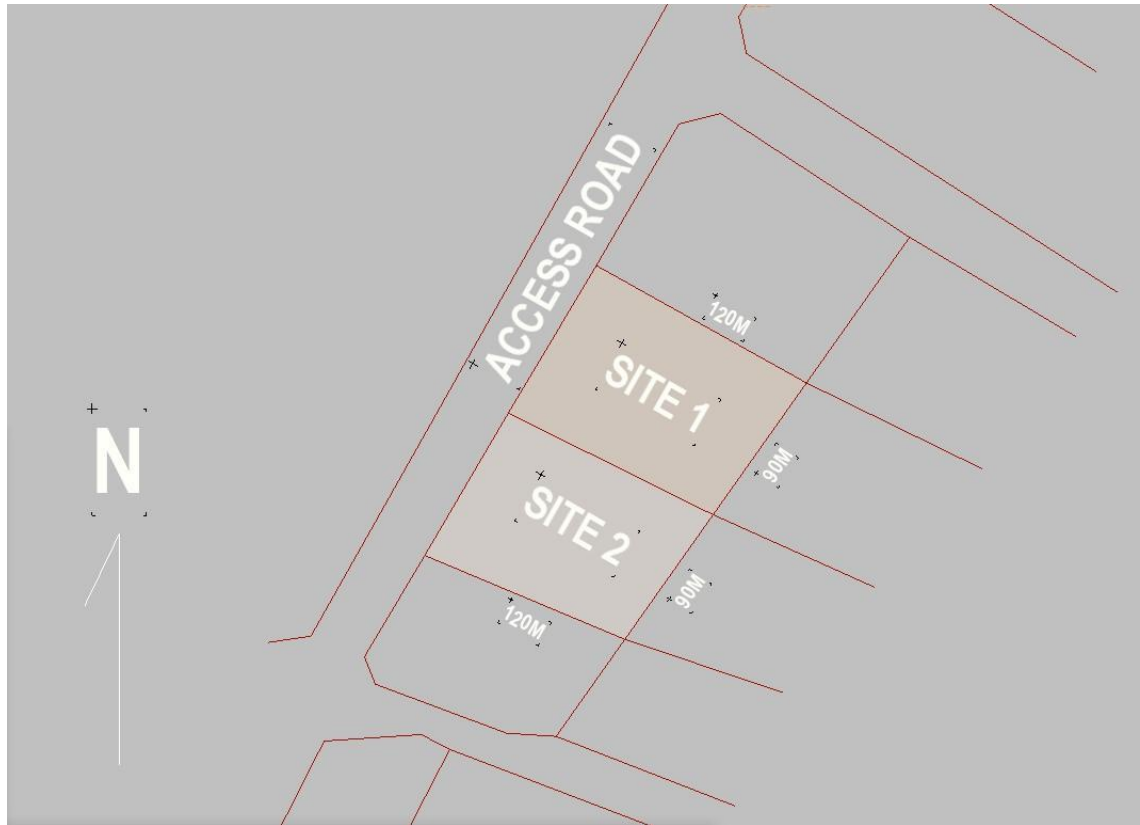

Estimate of sizes of sites 1 and 2 where the medical waste facility is to be set up (the entire area covered by site 1 and 2 is to be studied)

3. Environmental and Social Impact Assessment (ESIA)

The overall objective is to carry out a full Environmental and Social Impact Assessment (ESIA) and to provide the project with the key environmental factors to be considered during the planning, design, construction and operation of the proposed incinerator in addition to proposing relevant mitigation measures. This assessment is to be done in compliance with the National Environment Management Council (NEMC) requirements.

The specific objectives will include but not limited to:

- Screening and liaison with NEMC to establish the level of ESIA study applicable for the project site/magnitude
- Description of the location of the proposed development and its surrounding environs, including the coordinates for the site
- A concise description of the national environmental legislative and regulatory framework, baseline information, and any other information relevant to the project.
- The technology, procedures, processes and materials to be used in the implementation of the project
- To provide baseline information about the environmental, social and economic conditions in the project area;
- To identify, analyse and evaluate the type and extent of likely potential environmental and social impacts with emphasis on significance, magnitude and distribution of beneficial/adverse effects of the planned project on the existing biophysical, socio-economic and cultural components if any

- To ensure stakeholders involvement to the preparation of the project by carrying out public consultations, including potentially project affected persons, analyse their views regarding the environmental and social impacts, design social provisions and measures, formulate strategies for participatory implementation, recommend the incorporation of the findings into the project design and disclose as required, information to the public.
- Analyse the incineration process and the it's technology, environmental resources to be used during the operation, construction and determine the environmental risks, impacts and management
- The products, by-products and waste to be generated by the project
- Develop waste management plan for TMDA with adequate level of details specific enough to support the design and type of the proposed incinerator
- To develop an Environmental and Social Management Plans (ESMP). The ESMP shall outline the mitigation/enhancement, monitoring, consultative and institutional strengthening measures to prevent, minimise, mitigate or compensate for adverse environmental and social impacts and to enhance beneficial impacts, costs of the measures and monitoring requirements. The plans shall give an indicative timeframe and the responsible agent to implement the measures. This will also include recommendation of specific environmentally-sound management system for any toxic material or effluent resulting from the project
- An identification of gaps in knowledge and uncertainties encountered in compiling the information
- Undertake any tests required on site

4. **Assessment reporting and submission to National Environment Management Council (NEMC)**

- Preparation of ESIA report for submission to NEMC. The report will include but not limited to the following:
 - A detailed description of the proposed undertaking.
 - A description of the environment, with a focus on the elements that would be affected directly or indirectly (or could affect the project).
 - An analysis of localised risks /environmental and socio-economic effects of the project.
 - In particular, the ESIA will consider the following
 - localization factors
 - compatibility with land use planning of the area
 - Operation: possible management of incinerator waste, byproducts (residual ashes, waste water and emissions)
 - Mitigation measures: Technically and financially feasible options for reducing and mitigating identified risks and potential effects and making recommendations on the most appropriate in compliance with Tanzania environmental laws and regulations
 - An Environmental and Social Management Plan and a waste Management Plan/Strategy
- Present the ESIA report to NEMC for approval and certification. The consultant is to pay the required approval or statutory fees
- Respond to all comments and inputs from NEMC
- Any other tasks that may be required by NEMC and prevailing environmental legislation for the assignment.

5. Expected products

- Draft ESIA report submission to UNOPS
- Final ESIA report submission to NEMC for approval and certification
- Environmental Impact Assessment Licence from NEMC
- No objection letters from the affected community
- Any other related initiative.

Notes on safety measures

- The consultant shall ensure that all his staff and workers are equipped with Personal Protection Equipment (PPEs) against COVID 19 & other site safety measures before they are allowed to site.
- The consultant shall safeguard any kit or equipment used, personnel and all other resources from vandalism and harm at his/her own cost. The cost of all safety measures mentioned above, and any other internationally practised measures shall **not** be quoted separately but will be deemed covered in the price of bidder. A breach to any of the safety measures can lead to the termination of the contract.